

# Mobile telemetry load cell

with integrated strain gauge sensor element, for the measurement of cable tension and under hook crane / lifting gear weighing

## Characteristics

- Ranges from 1 t to 500 t
- For use with standard lifting shackles
- Distance 200 m
- Auto power down
- Up to 255 links can be used
- Accuracy 0,2 % of end-scale value
- Degree of protection IP 67 (load cell) respectively IP 65 (hand held display)
- Robust construction



## Description

The underhooked load cell has been specifically developed for the measurement of cable tension and under hook crane / lifting gear weighing. The accuracy achieved by this series is unrivalled in its price range and combines high quality with excellent value for money. The weight and overall height is very low, therefore reducing the headroom required for the installed system.

The load cell is environmentally sealed to IP 67 to give excellent waterproofing properties for use outside in arduous conditions. It is addressable to enable up to 255 units to be used on one installation.

The instrument is housed in a robust ABS enclosure with leather protective case. Operating at 433,92 MHz, the operator has only 3 front panel tactile switches ON/OFF, HOLD and TARE. The 8 character alpha numeric display is 7 mm high, and has 5 digit resolution.

Both load cell and hand held display include automatic power down, when not in use, to conserve battery life.

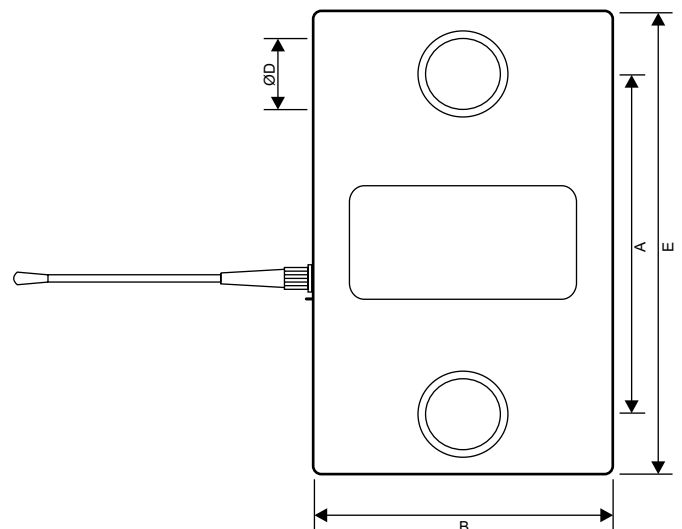

---

## Technical Data

<b><u>Input</u></b>	Ranges:	0 - 1, 2, 5, 12, 25, 35, 50, 100, 250, 500 t
	Overload:	Limit overload      max. 200 % of end-scale value Ultimate overload    max. 500 % of end-scale value
<b><u>Output</u></b>	Output:	by radio transmission to hand held display - optionally cable connection
	Distance:	200 m
<b><u>Accuracy</u></b>	Combined error:	+/- 0,2 % of end-scale value
<b><u>Power Supply</u></b>	Supply:	2 x 3,6 V Lithium battery
	Auto power down:	9 hrs. from power on
<b><u>Ambient Conditions</u></b>	Operating temperature:	- 10 to + 80 °C
<b><u>Dimensions</u></b>	Measure:	see table at page 3
	Material:	Anodised Aluminium
	Weight:	see table at page 3
	Degree of protection:	IP 67
	Terminal:	up to 255 links can be used in a single installation

## Hand Held Display

<b><u>Input</u></b>	Frequency:	433,92 Mhz
<b><u>Display</u></b>	Display:	8 character alpha numeric 7 mm high LCD
<b><u>Power Supply</u></b>	Supply:	9 V PP3 Lithium battery
	Auto power down:	after 5 min. in waiting mode
<b><u>Ambient Conditions</u></b>	Operating temperature:	- 10 to + 55 °C
<b><u>Dimensions</u></b>	Measure:	207 x 83 x 35 mm
	Material:	ABS
	Weight:	approx. 0,4 kg incl. leather case
	Degree of protection:	IP 65
	Keyboard:	3 key tactile ON/OFF, HOLD, TARE

## Operating, adjustment hints

### Dimensions hand held display

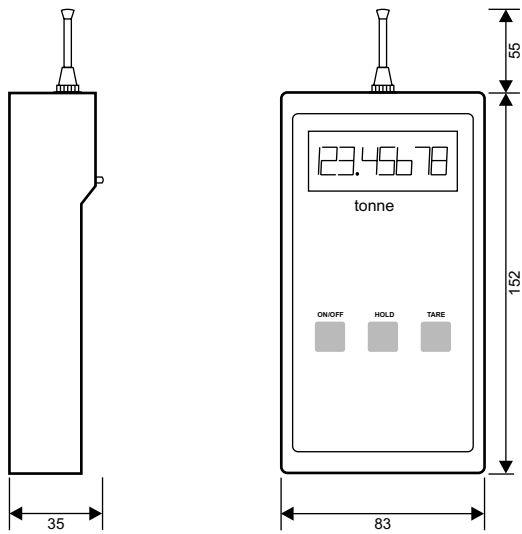

### Dimensions load cell

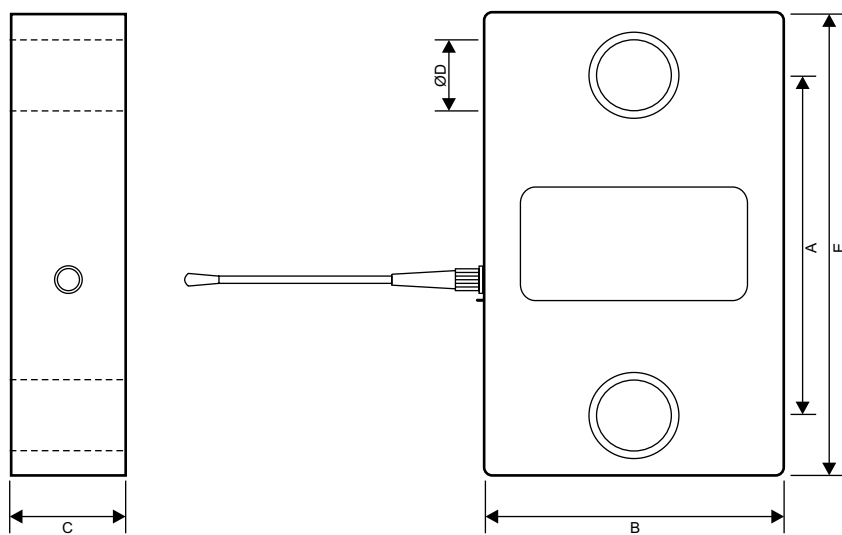

Range	A	B	C	Ø D	E	Weight kg
1, 2, 5 t	108	105	41,3	30	164	1,4
12 t	120	105	41,3	38	210	1,9
25 t	131	124	58	53	255	4
35 t	147	138	58	60	305	5
50 t	170	150	78	73	345	9
100 t	228	220	120	100	455	27
250 t	330	304	189	145	680	87
500 t	451	500	200	200	1015	225

## Ordering code

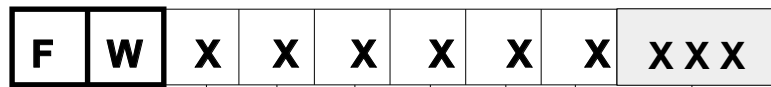

No.	Material	Version	Range				
0	Anodised Aluminium	Radio transmission	1 t				
1		Cable connection	2 t				
2			5 t				
3			12 t				
4			25 t				
5			35 t				
6			50 t				
7			100 t				
8			250 t				
9			500 t				